

*Continuous Forms
Processing & Mailing
Equipment*



SPEDO 7400 UNWINDER SPARE PARTS LIST

**SPEDO UK LTD, 76 WOOLMER WAY, BORDON, HAMPSHIRE GU35 9QF, UK
TEL: +44 (0) 1420 487442 • FAX: +44 (0) 1420 477827
E-MAIL: spedo@spedouk.com • WEBSITE: www.spedouk.com**

INDEX

ELECTRICAL PARTS	PAGE 3 – 13
OPERATOR SIDE ELECTRICAL PARTS	3 - 5
EXTERNAL INPUT PANEL PARTS	6
VACUUM BOX ELECTRICAL PARTS	7
DRIVER SIDE ELECTRICAL PARTS	8
PNEUMATIC CONTROL PARTS	9 - 11
PNEUMATIC PARTS	12
COMPRESSOR CABINET PARTS	13
MECHANICAL PARTS	PAGES 14 – 24
ROLLERS	14 - 15
SAFETY COVERS	16 - 17
PAPER REEL DRIVE SYSTEM	18 - 20
DRIVE SIDE PARTS	21
NON-DRIVE SIDE PARTS	22
PRIMARY DRIVE & SECONDARY DRIVE PARTS	23
PAPER REEL LIFT ARM	24

OPERATOR SIDE ELECTRICAL PARTS



1. SP 008 049
7400 OPERATOR PANEL
COMPLETE [SEE PAGE 5
FOR SPARE PARTS]



2. SP 008 051
7400 CONTROL PANEL



3. SP 007 607
SWITCH, EMERGENCY
STOP



4. SP 008 155
CABLE, SERIES
UP/DOWN SWITCH



5. SP 004 460
SWITCH, SAFETY COVER



6. SP 008 191
CABLE, ROLL UP
SENSOR



7. SP 008 192
CABLE, ROLL DOWN
SENSOR



8. SP 007 451
SAFETY COVER
SWITCH ASSEMBLY



9. SP 007 621
MOTOR, BLADE FIRE
SERVO



10. SP 008 150
SENSOR, DISTANCE



11. SP 008 103
CABLE, OPERATOR
RIBBON



SP 008 111
CABLE, EMERGENCY
STOP SWITCH

OPERATOR SIDE ELECTRICAL PARTS



SP 008 102
CABLE, SAFETY COVER
SWITCH



SP 007 882
FAN POWER CABLE



SP 008 101
CABLE, DANCER BAR
ULTRASONIC



SP 008 106
CABLE, RUNOUT SENSOR



SP 008 108
CABLE, REEL END SENSOR



SP 008 109
CABLE, BUFFER EMPTY
SENSOR



SP 008 110
CABLE, BUFFER FULL
SENSOR

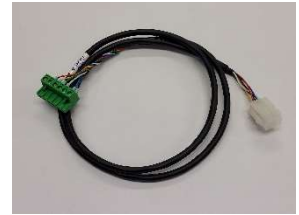

SP 008 227
CABLE, SERIES UP/DOWN
SWITCH INPUT



SP 008 166
CABLE, FAN POWER O/P



SP 008 212
CABLE, DOOR EARTH



SP 008 225
CABLE, E-STOP SWITCH,
INFLATOR PANEL



SP 008 149
SENSOR, REFLEX [REEL
END/PAPER OUT]

SP 008 049 - OPERATOR PANEL SPARE PARTS

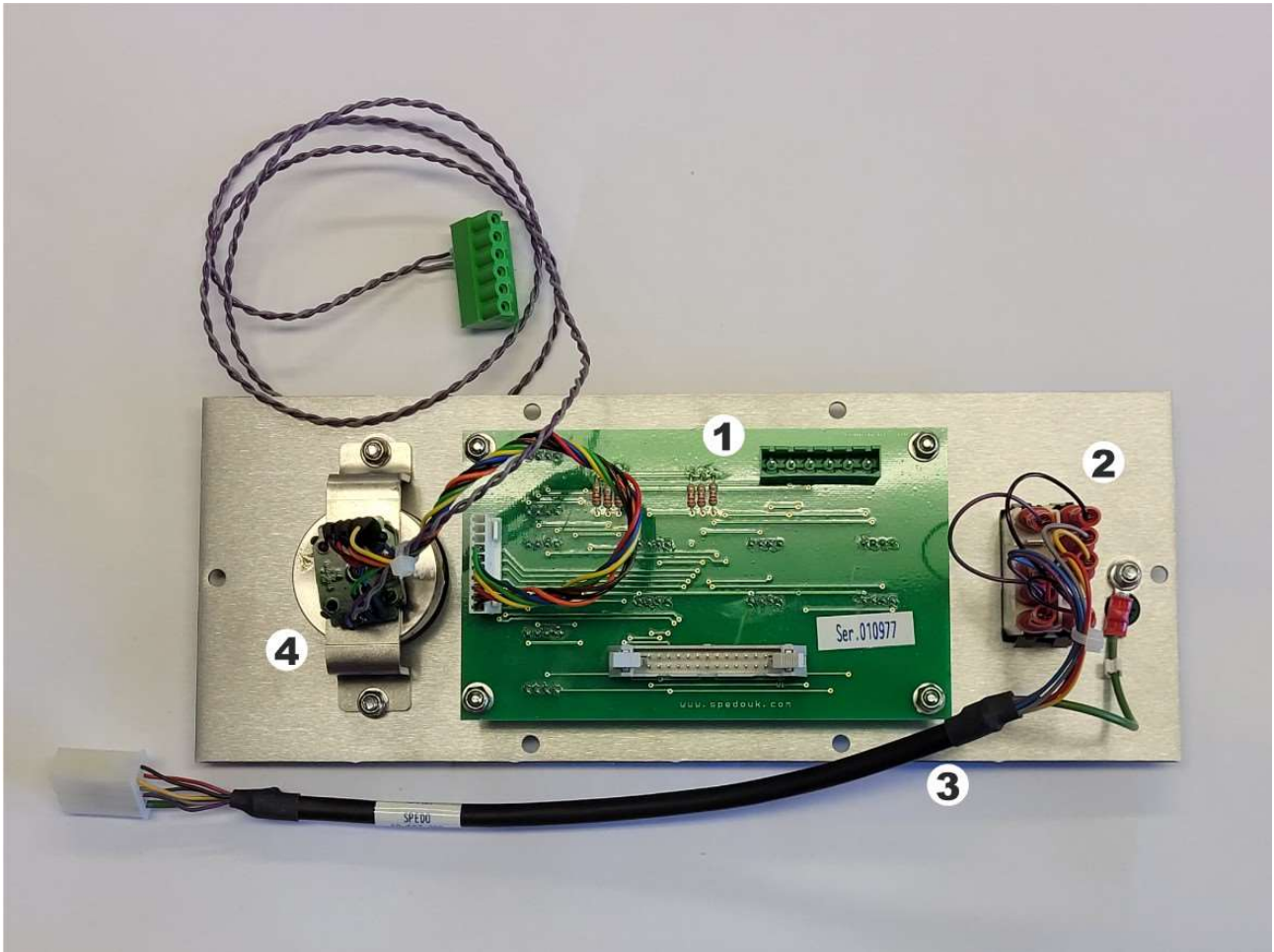

1. SP 008 047
OPERATOR PCB,
COMPLETE



SP 007 478
PCB, LED SWITCH,
WHITE



SP 007 479
PCB, LED SWITCH,
RED



SP 007 480
PCB, LED SWITCH,
GREEN



2. SP 007 606
SWITCH, ILLUMINATED
ROCKER



3. SP 007 895
CABLE, ON/OFF



4. SP 008 043
SWITCH, ROTARY
SPEED SELECTOR

EXTERNAL INPUT PANEL PARTS

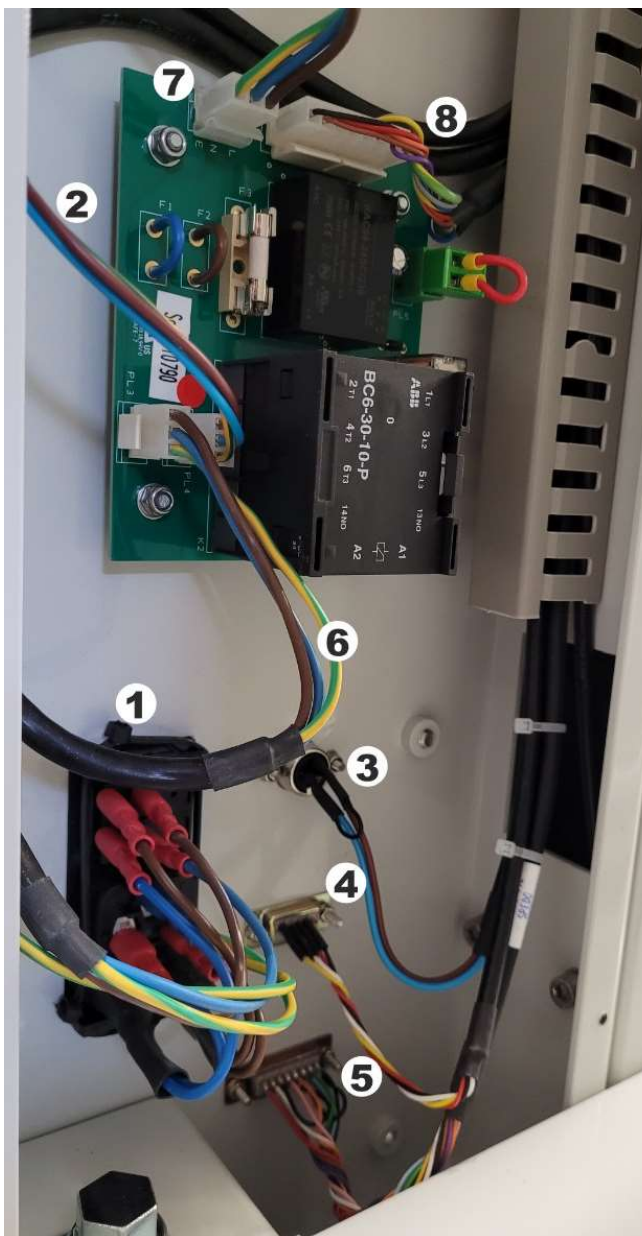

1. SP 008 186
MAINS INLET
ASSEMBLY



2. SP 008 187
POWER DISTRIBUTION
PCB



3. SP 008 104
CABLE, LOOP
CONTROL



4. SP 008 105
CABLE, E-NET



5. SP 008 112
CABLE, PRINTER
INTERFACE



6. SP 008 113
CABLE, MAIN INPUT



7. SP 008 189
CABLE, POWER
DISTRIBUTION, MAINS



8. SP 008 165
CABLE, ON/OFF SWITCH

VACUUM BOX ELECTRICAL PARTS



1. SP 005 051
FAN 230VAC



2. SP 008 151
SENSOR, PHOTOELECTRIC
[BUFFER FULL/LOW]



SP 007 882
FAN POWER CABLE

DRIVER SIDE ELECTRICAL PARTS

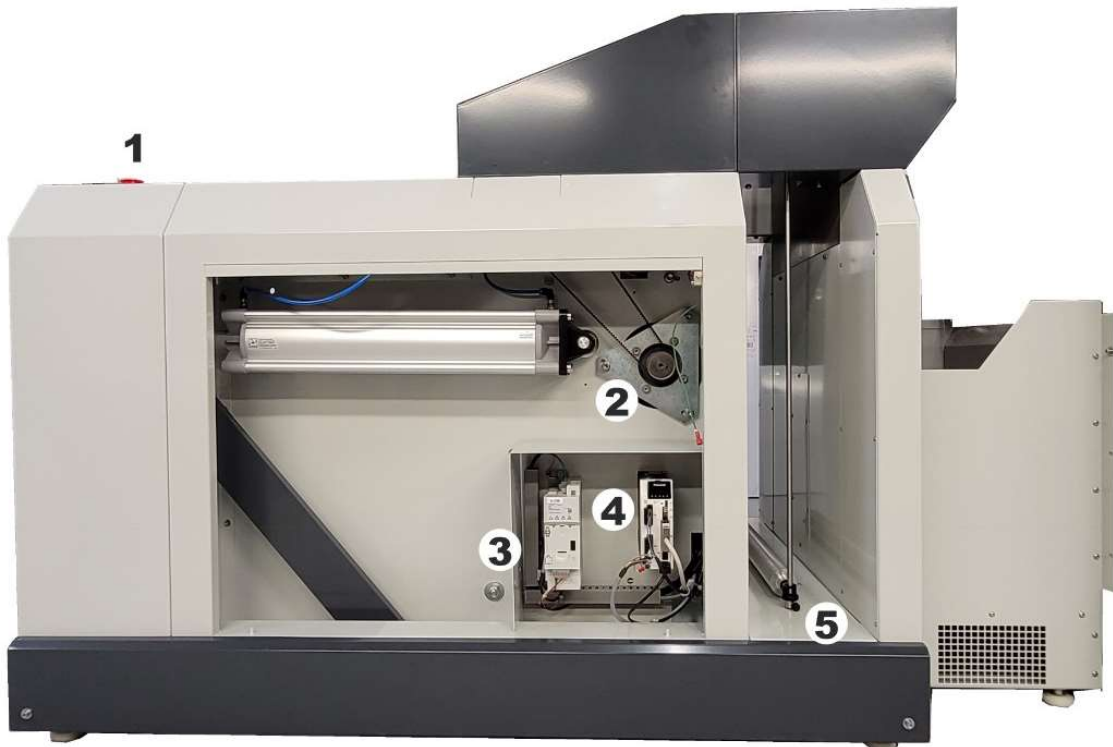

1. SP 007 607
SWITCH, EMERGENCY
STOP



2. SP 007 875
ROLL FEED MOTOR
ASSEMBLY



3. SP 007 876
ROLL FEED INVERTER
ASSEMBLY



4. SP 008 148
DRIVER, DANCER BAR
SERVO



5. SP 008 208
ROLL FEED BRAKE
ASSEMBLY



6. SP 004 460
SWITCH, SAFETY
COVER



SP 007 877
INVERTER POWER
CABLE



SP 008 211
CABLE, ROLL FEED
INVERTER I/O



SP 007 880
DANCER BAR SERVO
POWER CABLE



SP 007 881
DANCER BAR SERVO
ENCODER CABLE



SP 007 878
DANCER BAR SERVO
I/O CABLE



SP 007 879
DANCER BAR SERVO
MOTOR CABLE

PNEUMATIC CONTROL PARTS

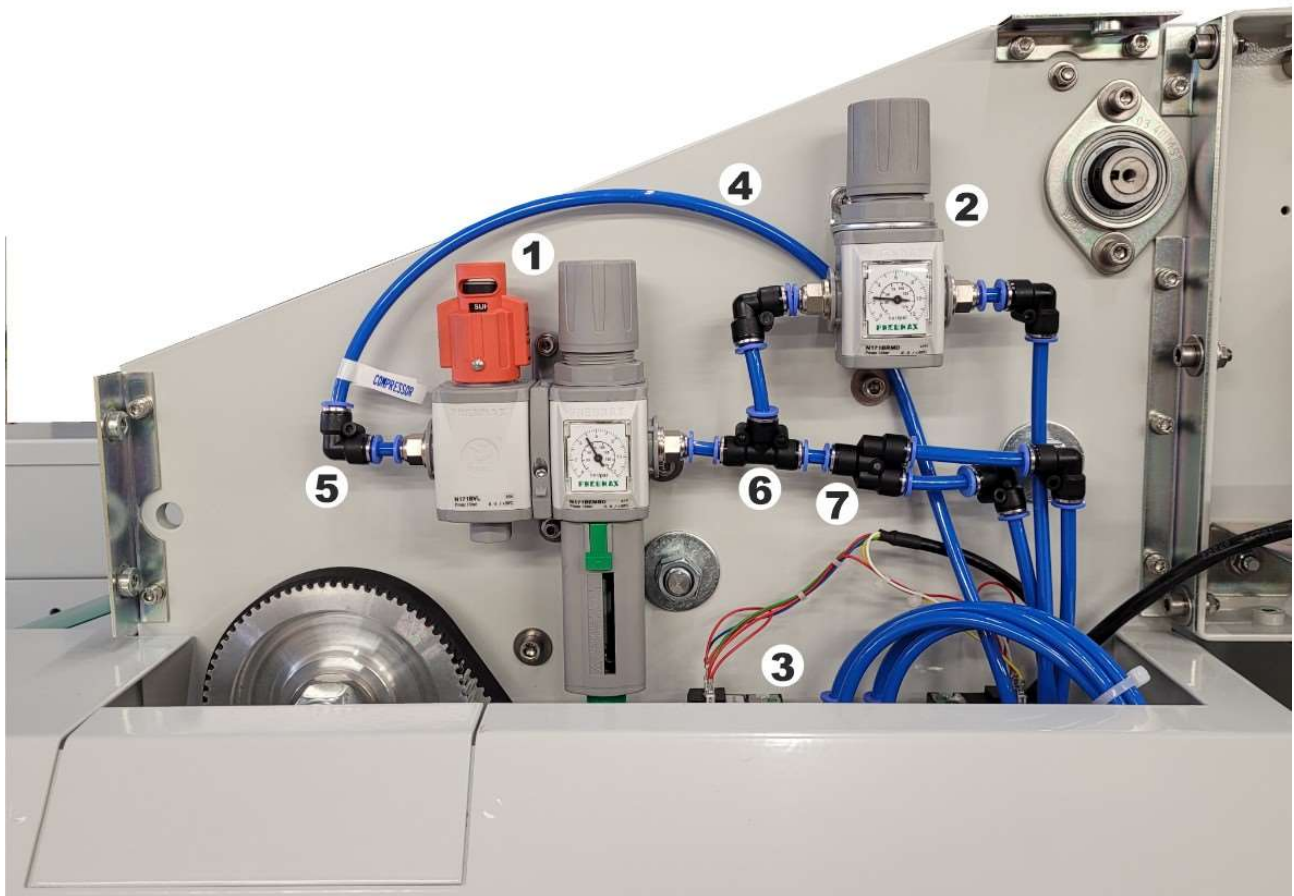

1. SP 008 137
FILTERED REGULATOR
ASSEMBLY [SEE PAGE
10 FOR SPARE PARTS]



2. SP 008 138
BELT LIFT REGULATOR
ASSEMBLY [SEE PAGE
10 FOR SPARE PARTS]



3. SP 008 131
CONTROL VALVE
ASSEMBLY [SEE PAGE
11 FOR SPARE PARTS]



4. SP 008 068
TUBING, 6MM O/D



5. SP 008 073
FITTING, 6MM EQUAL
ELBOW



6. SP 008 072
FITTING, 6MM EQUAL
TEE



7. SP 008 140
FITTING, 6MM EQUAL
Y

SP 008 137 FILTERED REGULATOR ASSEMBLY SPARE PARTS

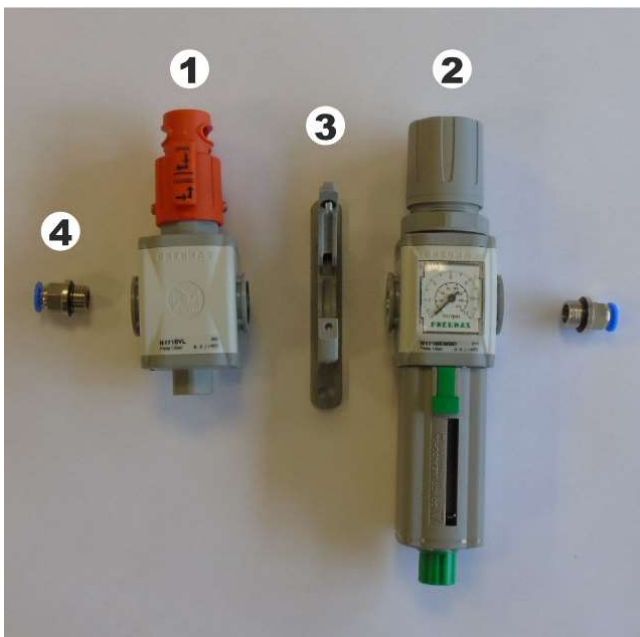

1. SP 008 063
SHUT OFF VALVE



2. SP 008 064
FILTER REGULATOR C/W
FILTER



3. SP 008 066
COUPLING KIT WITH
MOUNTING HOLES



4. SP 008 069
FITTING, 6MM-1/4"
STRAIGHT MALE
ADAPTOR

SP 008 138 BELT LIFT REGULATOR ASSEMBLY SPARE PARTS



1. SP 008 065
PRESSURE REGULATOR
C/W GAUGE



2. SP 008 071
BRACKET, REGULATOR
FIXING



3. SP 008 069
FITTING, 6MM-1/4"
STRAIGHT MALE
ADAPTOR

SP 008 131 CONTROL VALVE ASSEMBLY SPARE PARTS

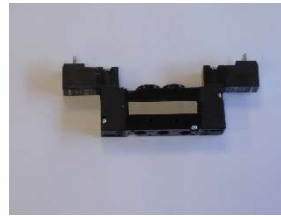
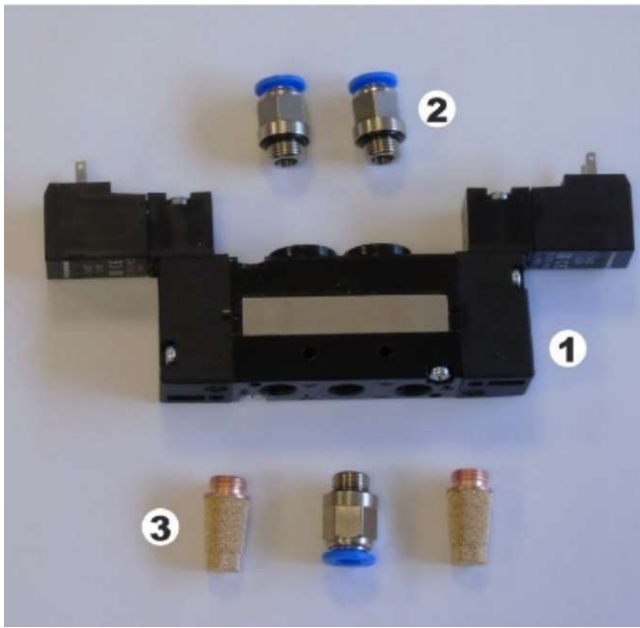

1. SP 008 061
CONTROL VALVE,
24VDC



2. SP 008 070
FITTING, 6MM-G 1/8",
STRAIGHT MALE
ADAPTOR



3. SP 008 062
SILENCER, 1/8"

4.

PNEUMATIC PARTS



- 1. SP 008 136
ROLL LIFT CYLINDER COMPLETE

SP 008 136 ROLL LIFT CYLINDER SPARE PARTS

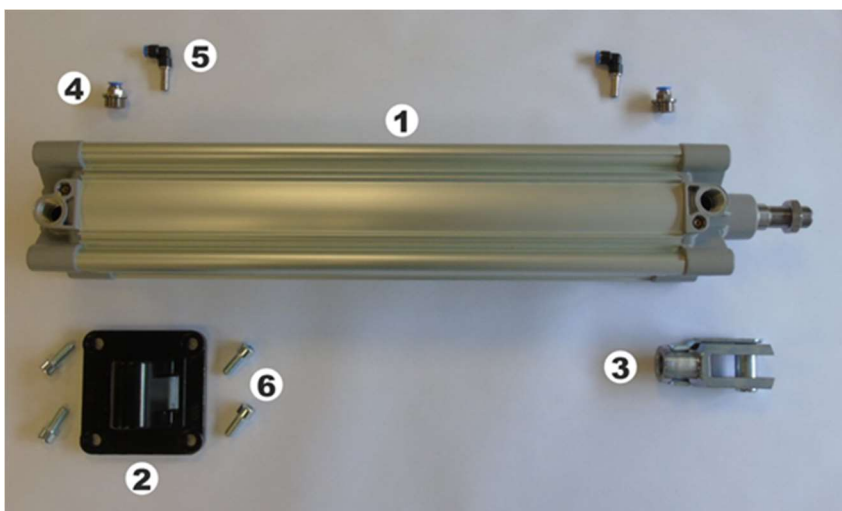

- 1. SP 008 053
CYLINDER, 100MM x 145MM
STROKE



- 2. SP 008 054
CLEVIS, REAR MALE



- 3. SP 008 055
CLEVIS, PISTON ROD



- 4. SP 008 134
FITTING, 8MM-G 1/2",
STRAIGHT MALE
ADAPTOR



- 5. SP 008 133
FITTING, 8MM-6MM,
STEM ELBOW
REDUCER



- 6. SP 008 135
SCREW, M10 x 25,
SOCKET CAP

COMPRESSOR CABINET PARTS



1. SP 008 132
CYLINDER, BELT LIFT
COMPLETE



2. SP 008 174
COMPRESSOR ASSEMBLY

SP 008 132 CYLINDER BELT LIFT SPARE PARTS

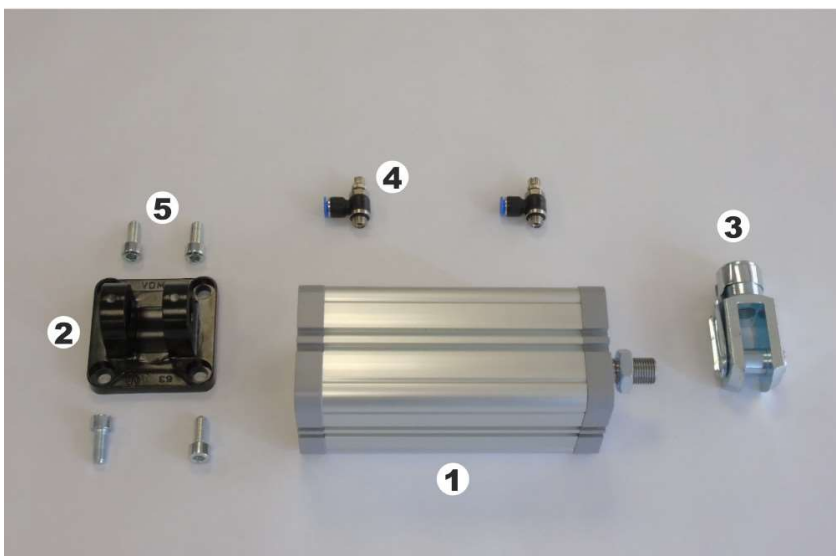

1. SP 008 057
CYLINDER, 63MM X 125MM
STROKE



2. SP 008 058
CLEVIS, NARROW REAR



3. SP 008 059
CLEVIS, PISTON ROAD



4. SP 008 060
VALVE, FLOW
CONTROL FOR 1540
CYLINDER



5. SP 000 993
SCREW, M6 X 20,
SOCKET CAP

ROLLERS



SECONDARY DRIVE ROLLER

SECONDARY IDLE ROLLER

WEB TENSION ROLLER

SECONDARY DRIVE ROLLER

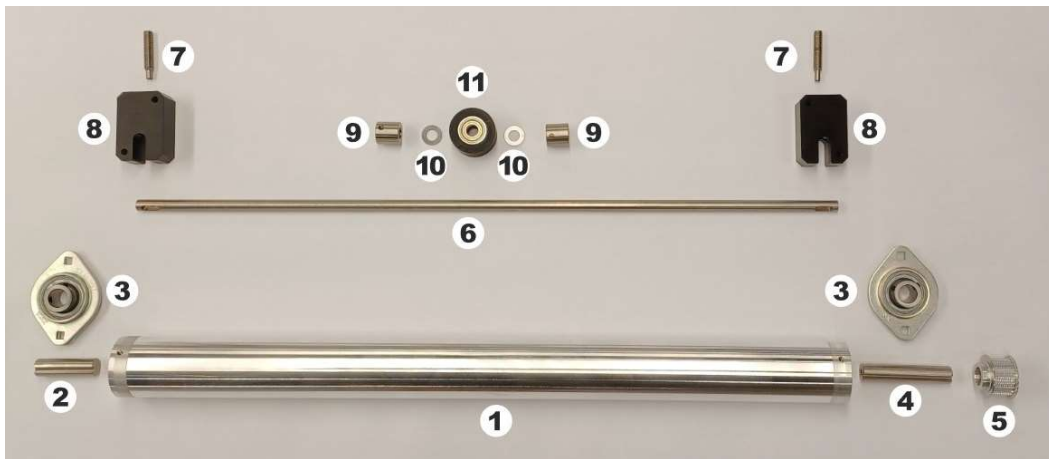

1. SP 008 001
DRIVE ROLLER
COMPLETE



2. SP 006 783
SHAFT, ROLLER
DRIVE, 50MM



3. SP 002 133
BEARING



4. SP 006 784
SHAFT, ROLLER
DRIVE, 75MM



5. SP 006 816
PULLEY, ROLLER DRIVE



6. SP 008 004
PRESSURE ROLLER
CROSS BAR



7. SP 006 828
SPRING PLUNGER
ASSEMBLY



8. SP 0006 781
BLOCK, PRESSURE
ROLLER



9. SP 006 815
COLLAR, PRESSURE
ROLLER



10. SP 004 703
WASHER, SPECIAL,
M12



11. SP006 831
PRESSURE ROLLER
COMPLETE

SECONDARY IDLE ROLLER

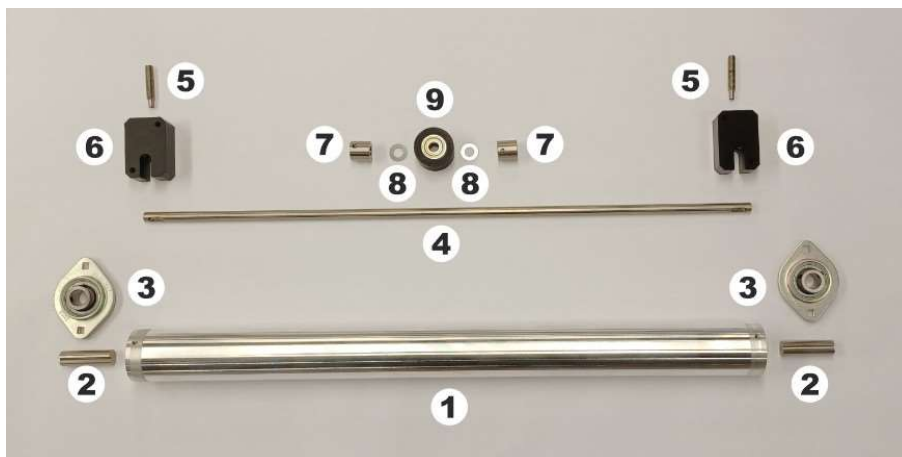

1. SP 008 001
DRIVE ROLLER
COMPLETE



2. SP 006 783
SHAFT, ROLLER
DRIVE, 50MM



3. SP 002 133
BEARING



4. SP 008 004
PRESSURE ROLLER
CROSS BAR



5. SP 006 828
SPRING PLUNGER
ASSEMBLY



6. SP 006 781
BLOCK, PRESSURE
ROLLER



7. SP 006 815
COLLAR, PRESSURE
ROLLER



8. SP 004 703
WASHER, SPECIAL,
M12



9. SP 006 831
PRESSURE ROLLER
COMPLETE

WEB TENSION ROLLER



1. SP 008 175
WEB TENSION ROLLER
ASSEMBLY



2. SP 006 820
GUIDE, TENSION
ROLLER

SAFETY COVERS



- 1. SP 008 007
FRONT SAFETY COVER
- 2. SP 007 985
REAR SAFETY COVER
- 3. SP 008 000
DRIVE BELT COVER

FRONT SAFETY COVER SPARE PARTS

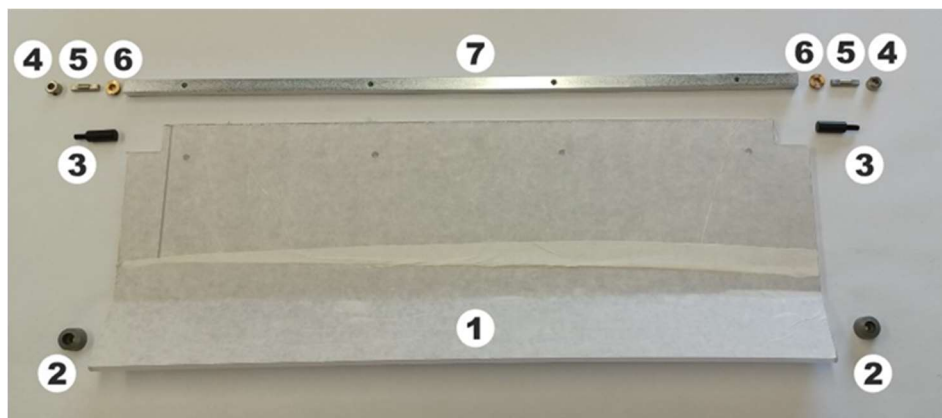

1. SP 008 007
FRONT SAFETY COVER



2. SP 001 639
FOOT



3. SP 006 833
SAFETY COVER STOP
COMPLETE



4. SP 000 683
COLLAR, SET



5. SP 006 812
SPINDLE, SAFETY
COVER



6. SP 004 726
BUSH

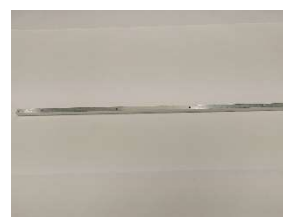

7. SP 008 024
SAFETY COVER BAR

REAR SAFETY COVER SPARE PARTS

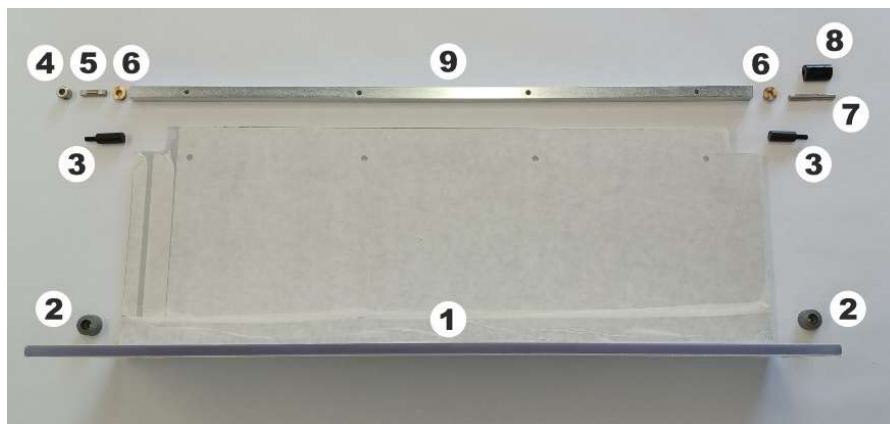

1. SP 007 985
REAR SAFETY COVER



2. SP 001 639
FOOT



3. SP 006 833
SAFETY COVER STOP
COMPLETE



4. SP 000 683
COLLAR, SET



5. SP 006 812
SPINDLE, SAFETY
COVER



6. SP 004 726
BUSH



7. SP 006 811
SPINDLE, SAFETY
COVER CAM



8. SP 006 810
CAM, SAFETY COVER

PAPER REEL DRIVE SYSTEM



PAPER REEL DRIVE SYSTEM SPARE PARTS



1. SP 008 178
FREE TENSION ROLLER
ASSEMBLY



2. SP 008 176
PAPER FEED BELT
DRIVE SHAFT SPACER



3. SP 007 940
PAPER FEED BELT
DRIVE SHAFT



4. SP 008 164
WAVE WASHER



5. SP 008 144
BEARING, DRIVE SHAFT



6. SP 007 999
BELT DRIVE HOUSING
END PLATE, LH



7. SP 008 016
BELT DRIVE HOUSING
END PLATE, RH



8. SP 008 177
BELT DRIVE BEARING
HOUSING ASSEMBLY

PAPER REEL DRIVE SYSTEM SPARE PARTS

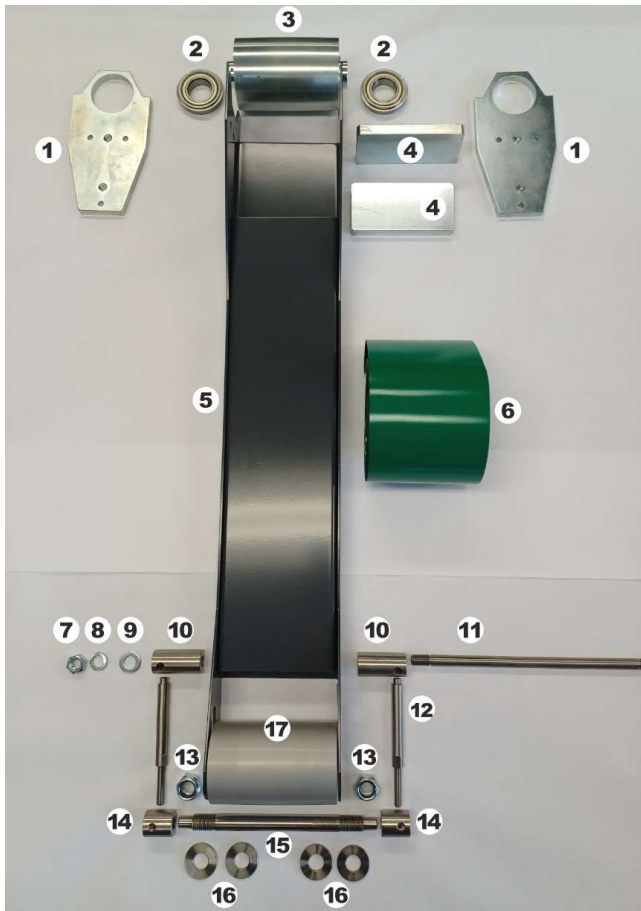

1. SP 007 954
DRIVE BELT ARM
BEARING HOUSING



2. SP 008 145
BEARING, DRIVE SHAFT



3. SP 008 201
DRIVE BELT DRIVE
ROLLER ASSEMBLY



4. SP 007 953
BELT DRIVE ARM
BRACE PLATE



5. SP 007 960
DRIVE BELT ARM



6. SP 008 157
PAPER REEL DRIVE
BELT



7. SP 008 167
NUT, M12,
STANDARD



8. SP 008 168
SPRING WASHER, M12



9. SP 008 179
WASHER, M12,
STANDARD



10. SP 007 958
PAPER DRIVE TENSION
ROLLER SHAFT
ADJUSTER SPIGOT



11. SP 007 959
PAPER DRIVE
TENSION ROLLER
SHAFT SPIGOT SHAFT



12. SP 008 200
BELT TENSIONER
SHAFT



13. SP 008 160
NUT, NYLOCK, M20



14. SP 007 957
PAPER DRIVE TENSION
ROLLER SHAFT
ADJUSTER

PAPER REEL DRIVE SYSTEM SPARE PARTS

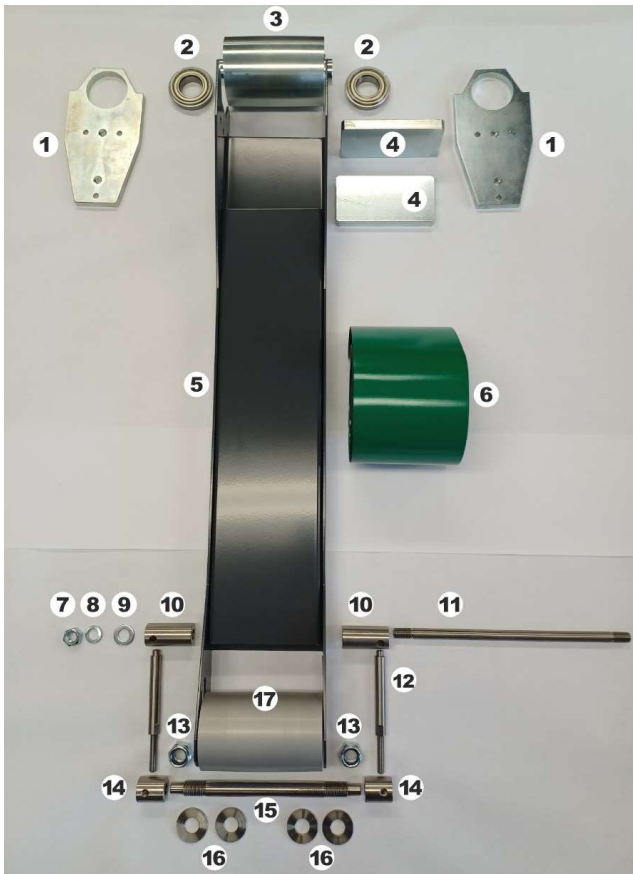

15. SP 007 956
PAPER DRIVE TENSION
ROLLER SHAFT



16. SP 007 955
SPACER WASHER



17. SP 008 183
PAPER REEL DRIVE
BELT TENSIONER
PULLEY ASSEMBLY

DRIVE SIDE

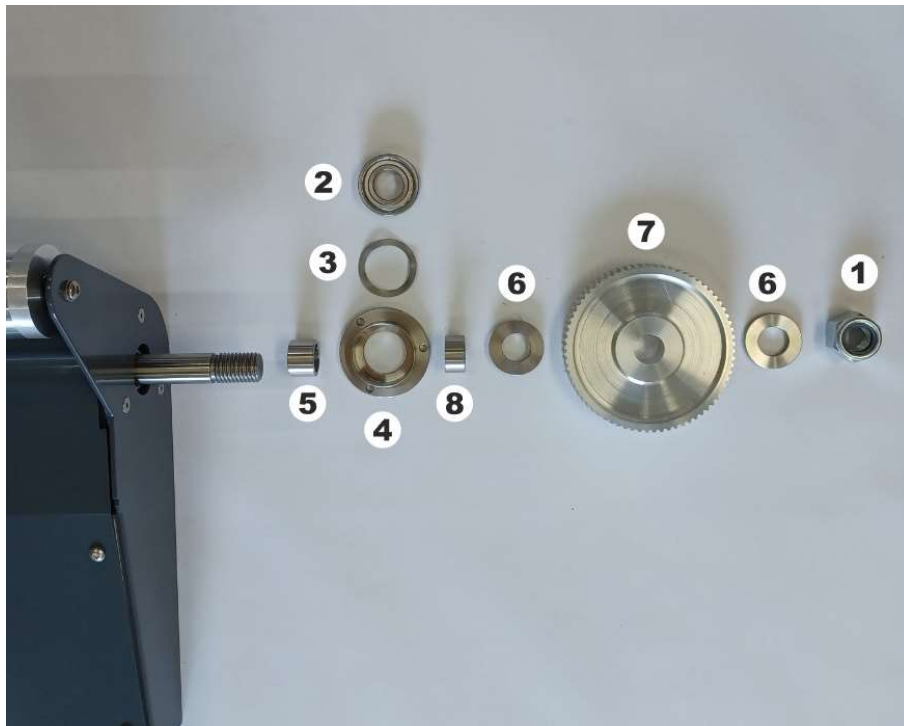

1. SP 008 160
NUT, NYLOCK, M20



2. SP 004 762
BEARING



3. SP 008 163
WAVE WASHER



4. SP 007 937
DRIVE SHAFT BEARING
MOUNT



5. SP 007 938
SPACER RING



6. SP 007 935
SPACER WASHER



7. SP 008 159
PAPER REEL DRIVE
PULLEY



8. SP 007 936
SPACER RING

NON-DRIVE SIDE

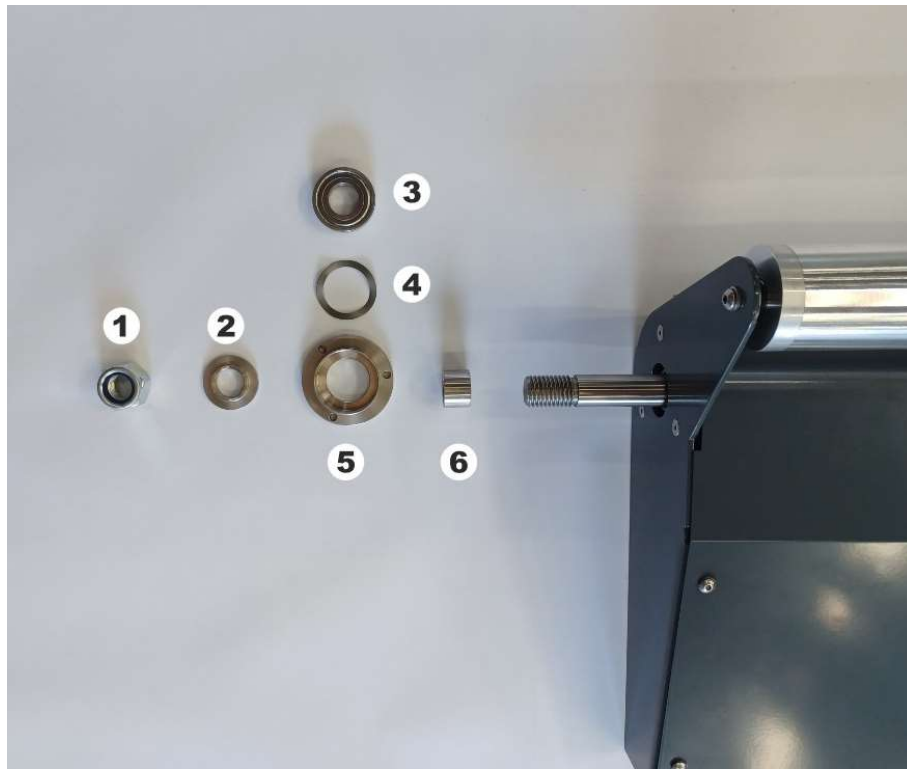

1. SP 008 160
NUT, NYLOCK, M20



2. SP 007 939
THRUST WASHER



3. SP 004 762
BEARING



4. SP 008 163
WAVE WASHER



5. SP 007 937
DRIVE SHAFT BEARING
MOUNT



6. SP 007 938
SPACER RING

PRIMARY DRIVE

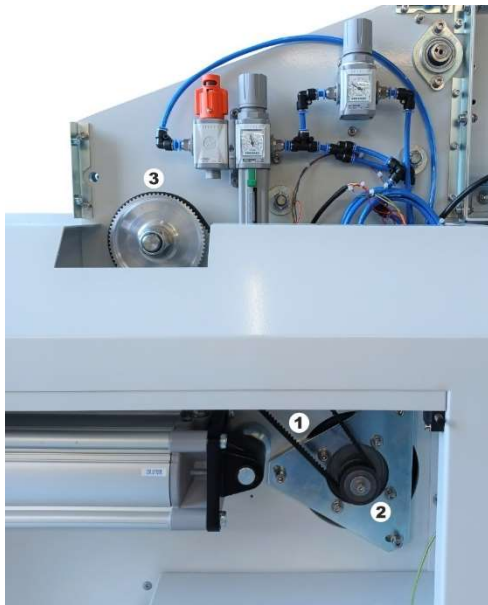

SECONDARY DRIVE

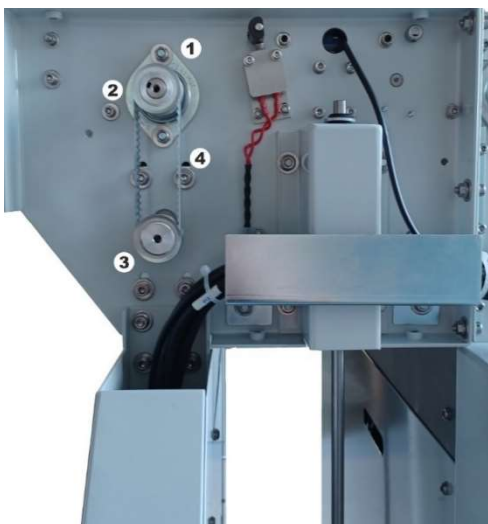

PAPER REEL LIFT ARM

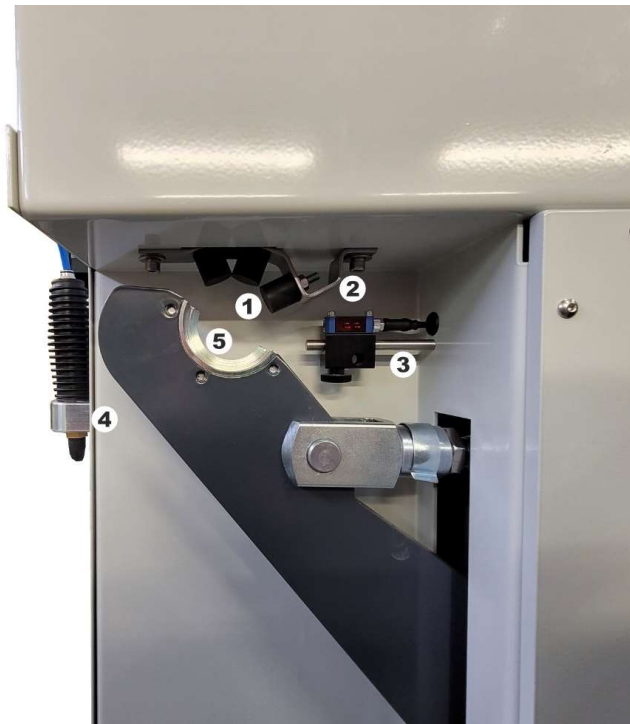

1. SP 008 204
AIRSHAFT STOPPER
RUBBER BUFFER



2. SP 008 203
AIRSHAFT STOPPER
BRACKET



3. SP 008 236
REEL END SENSOR
MOUNT BAR



4. SP 008 030
INFLATOR GUN HOLDER



5. SP 007 966
REEL LIFT ARM
BEARING CUP